

Soils Map

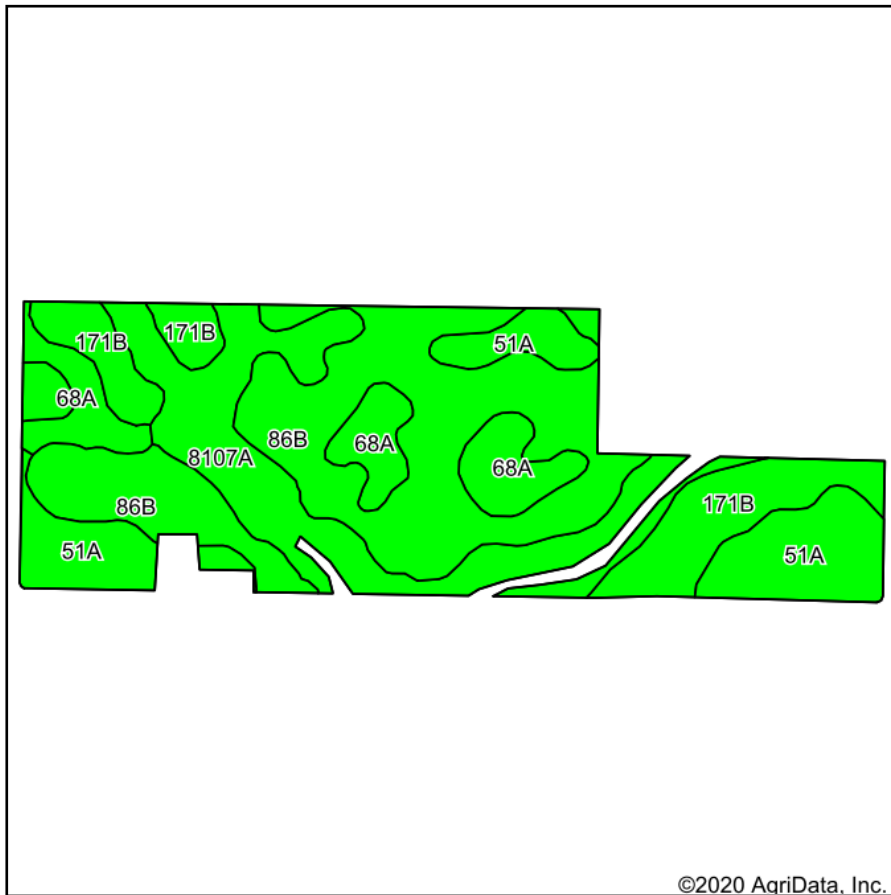

Soils data provided by USDA and NRCS.

©2020 AgriData, Inc.

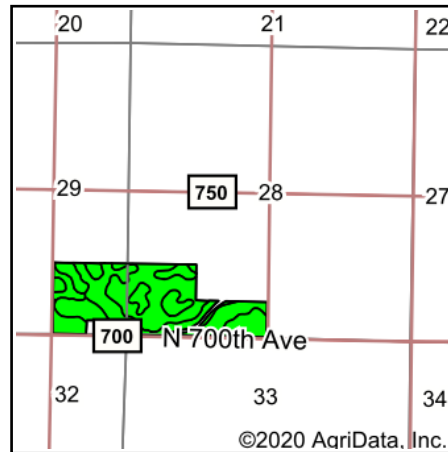

State: **Illinois**
 County: **Putnam**
 Location: **28-32N-1W**
 Township: **Granville**
 Acres: **94.38**
 Date: **8/31/2020**



Maps Provided By:



© AgriData, Inc. 2020

www.AgriDataInc.com



Area Symbol: IL155. Soil Area Version: 15							
Code	Soil Description	Acres	Percent of field	Il. State Productivity Index Legend	Corn Bu/A	Soybeans Bu/A	Crop productivity index for optimum management
**86B	Osco silt loam, 2 to 5 percent slopes	34.91	37.0%		**189	**59	**140
8107A	Sawmill silty clay loam, 0 to 2 percent slopes, occasionally flooded	19.45	20.6%		189	60	139
51A	Muscataune silt loam, 0 to 2 percent slopes	16.83	17.8%		200	64	147
**171B	Catlin silt loam, 2 to 5 percent slopes	12.98	13.8%		**185	**58	**137
68A	Sable silty clay loam, 0 to 2 percent slopes	10.21	10.8%		192	63	143
Weighted Average					190.7	60.4	141

Table: Optimum Crop Productivity Ratings for Illinois Soil by K.R. Olson and J.M. Lang, Office of Research, ACES, University of Illinois at Champaign-Urbana. Version: 1/2/2012 Amended Table S2 B811

Crop yields and productivity indices for optimum management (B811) are maintained at the following NRES web site: <http://soilproductivity.nres.illinois.edu/>

** Indexes adjusted for slope and erosion according to Bulletin 811 Table S3

Soils data provided by USDA and NRCS. Soils data provided by University of Illinois at Champaign-Urbana.