

# SUBSURFACE WASTEWATER DISPOSAL SYSTEM APPLICATION

Department of Human Services  
Division of Health Engineering  
(207) 287-5672 FAX (207) 287-4172

<b>PROPERTY LOCATION</b>		LURC 131      PERMIT # 308      STATE COPY Date Permit Issued: <u>11.10.98</u> \$ <u>1,240</u> <input checked="" type="checkbox"/> FEE <input checked="" type="checkbox"/> Double Fee Charged <u>Chad E. R. C.</u> L.P.I. # <u>1,13,1</u> Local Plumbing Inspector Signature	
Town or Plantation	<u>T5R8</u>		
Street Subdivision Lot #	<u>Bowlin Camps Cabin's #2 + 3</u>		
<b>PROPERTY OWNERS NAME</b>			
Last: <u>Smallwood</u>	First: <u>Jon + Betty</u>		
Mailing Address of Owner	<u>P.O. Box 251</u>		
	<u>Patten, ME. 04765</u>		
Daytime Tel. #	<u>207-528-2022</u>	Municipal Tax Map # _____ Page # _____	
<b>Owner Statement</b>		<b>Caution: Inspection Required</b>	
I state that the information submitted is correct to the best of my knowledge and understand that any falsification is reason for the Department and/or Local Plumbing Inspector to deny a Permit. <u>Jon Smallwood</u> Signature of Owner/Applicant      Date _____		I have inspected the installation authorized above and found it to be in compliance with the Subsurface Wastewater Disposal Rules Application. <u>Chad E. R. C.</u> <u>6/20/99</u> Local Plumbing Inspector Signature      Date Approved	

## PERMIT INFORMATION

<b>THIS APPLICATION IS FOR:</b> 1. <input type="checkbox"/> First Time System 2. <input type="checkbox"/> Multi-User System 3. <input checked="" type="checkbox"/> Replacement System 4. <input type="checkbox"/> Expanded System a. <input type="checkbox"/> One-time exempted b. <input type="checkbox"/> Non-exempted 5. <input type="checkbox"/> Experimental System 6. <input type="checkbox"/> Seasonal Conversion	<b>THIS APPLICATION REQUIRES:</b> 1. <input checked="" type="checkbox"/> No Rule Variance 2. <input type="checkbox"/> First Time System Variance (Municipal) 3. <input type="checkbox"/> First Time System Variance (State) 4. <input checked="" type="checkbox"/> Replacement System Variance a. <input type="checkbox"/> Local Plumbing Inspector approval b. <input type="checkbox"/> State & Local Plumbing Inspector approval 5. <input type="checkbox"/> Minimum Lot Size Variance 6. <input type="checkbox"/> Seasonal Conversion Variance	<b>DISPOSAL SYSTEM COMPONENT(S)</b> 1. <input checked="" type="checkbox"/> Non-Engineered System 2. <input type="checkbox"/> Primitive System 3. <input type="checkbox"/> Alternative Toilet Specify _____ 4. <input type="checkbox"/> Non-Engineered Treatment Tank 5. <input type="checkbox"/> Holding Tank _____ Gallons 6. <input type="checkbox"/> Non-Engineered Disposal Area (only) 7. <input type="checkbox"/> Separated Laundry System 8. <input type="checkbox"/> Engineered System (+2000 gpd) 9. <input type="checkbox"/> Engineered Treatment Tank (only) 10. <input type="checkbox"/> Engineered Disposal Area (only)
<b>SIZE OF PROPERTY</b> <u>30 Ac ±</u>	<b>DISPOSAL SYSTEM TO SERVE:</b> 1. <input type="checkbox"/> Single Family Dwelling Unit 2. <input type="checkbox"/> Multiple Family Dwelling Unit Number of Units _____ 3. <input checked="" type="checkbox"/> Other <u>Rental Cabins</u> SPECIFY _____	
<b>SHORELAND ZONING</b> <input type="checkbox"/> Yes <input checked="" type="checkbox"/> No	<b>TYPE OF WATER SUPPLY</b> <u>Spring Water</u> <u>Gravity Feed</u>	

## DESIGN DETAILS (SYSTEM LAYOUT SHOWN ON PAGE 3)

<b>TREATMENT TANK</b> 1. <input checked="" type="checkbox"/> Concrete <input checked="" type="checkbox"/> Regular <input type="checkbox"/> Low Profile 2. <input type="checkbox"/> Plastic SIZE <u>1000</u> Gallons	<b>DISPOSAL AREA TYPE/SIZE</b> 1. <input type="checkbox"/> Stone Bed _____ Sq. Ft. 2. <input checked="" type="checkbox"/> Proprietary Device <u>850</u> Sq. Ft. <input type="checkbox"/> Clustered <input checked="" type="checkbox"/> Linear <input checked="" type="checkbox"/> Regular <input type="checkbox"/> H-20 3. <input type="checkbox"/> Trench _____ Lin. Ft. 4. <input type="checkbox"/> Other _____	<b>GARBAGE DISPOSAL UNIT</b> 1. <input checked="" type="checkbox"/> No 2. <input type="checkbox"/> Yes <input type="checkbox"/> Multi-compartment tank <input type="checkbox"/> Tank in series <input type="checkbox"/> Increase in tank capacity <input type="checkbox"/> Filter on tank outlet	<b>CRITERIA USED FOR DESIGN FLOW</b> (Show Calculations) <u>Cabin #3</u> <u>8 Beds x 35 GPD ea</u> <u>= 280 GPD</u> <u>Cabin #2</u> <u>3 Beds x 40 GPD ea</u> <u>= 120 GPD</u> DESIGN FLOW: <u>400</u> (Gallons/Day)
<b>PROFILE &amp; DESIGN CLASS</b> PROFILE      DESIGN <u>6</u> <u>B</u> DEPTH TO MOST LIMITING FACTOR _____	<b>DISPOSAL AREA SIZING</b> 1. <input checked="" type="checkbox"/> Small 2.0 2. <input type="checkbox"/> Medium 2.60 3. <input type="checkbox"/> Medium-Large 3.30 4. <input type="checkbox"/> Large 4.10 5. <input type="checkbox"/> Extra-Large 5.00	<b>PUMPING</b> 1. <input checked="" type="checkbox"/> Not required 2. <input type="checkbox"/> May be required 3. <input type="checkbox"/> Required DOSE _____ Gallons	

## SITE EVALUATOR'S STATEMENT

On 4/22/98 (date) I completed a site evaluation on this property and state that the data reported is accurate and that the proposed system is in compliance with the Subsurface Wastewater Disposal Rules. Revised 8/26/98

John R. Whitney  
 Site Evaluator Signature  
John R. Whitney  
 Print Name

239  
 SE #  
207-794-8627  
 Telephone

5/5/98  
 Date

Town, City or Plantation

75 R8

Street, Road or Subdivision

Name of Owner

# Bowlin Camps

## SITE PLAN

Cabin # 3

Ton  
Ft.

Smallwood

Scale: 1" =  
or as shown

SITE LOCATION PLAN  
(Map from *The Maine Atlas*  
recommended)

see attached  
MAP

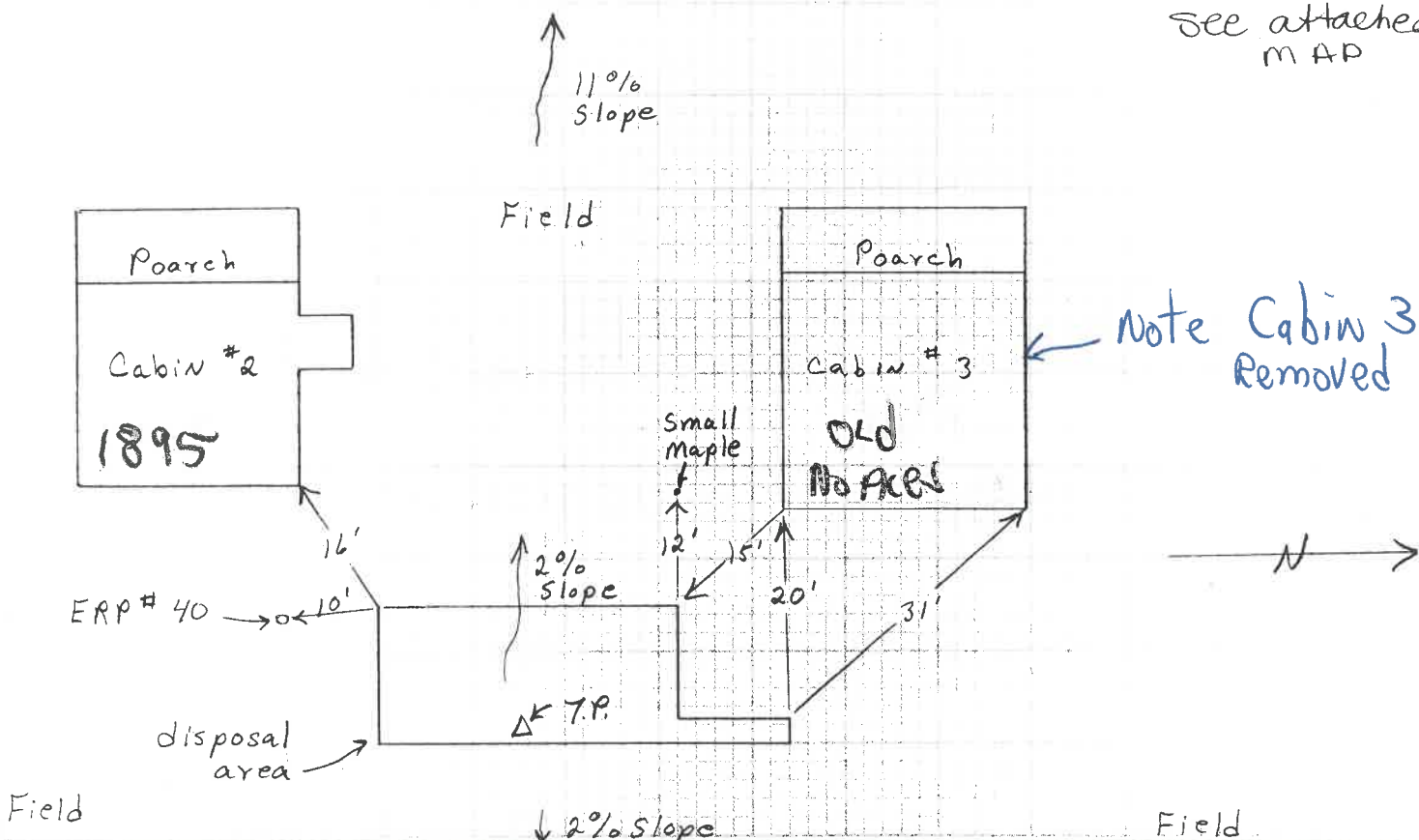

(Location of Observation Holes Shown Above)

Observation Hole T.P.      ☒ Test Pit      ☐ Boring

0" Depth of Organic Horizon Above Mineral Soil

	Texture	Consistency	Color	Mottling
0	Gravelly Loam	Friable	10YR3/4	
6				
10	Loamy		10YR4/4	
15	Gravel			
20	Gravel	Loose	2.5Y3/3	
30				
40				
50				

Soil 6  
Profile

Class B

Slope \_\_\_\_\_%  
Limiting Factor \_\_\_\_\_"

☐ Ground Water  
☐ Restrictive Layer  
☐ Bedrock

Observation Hole \_\_\_\_\_ ☐ Test Pit ☐ Boring  
 \_\_\_\_\_ " Depth of Organic Horizon Above Mineral Soil

	Texture	Consistency	Color	Mottling
0				
6				
10				
15				
20				
30				
40				
50				

Soil _____ Profile	Class _____	Slope _____%	Limiting Factor _____ "	<input type="checkbox"/> Ground Water <input type="checkbox"/> Restrictive Layer <input type="checkbox"/> Bedrock
--------------------------	----------------	-----------------	----------------------------	---

Revised 8/26/98

5/5/98  
Date

John R. Whitney  
Site Evaluator Signature

239  
SE #



# SUBSURFACE WASTEWATER DISPOSAL SYSTEM APPLICATION

Town, City or Plantation

Street, Road or Subdivision

Name of Owner

TSR8

Bowlin Camps

Cabin #3

Jon Smallwood

## SUBSURFACE WASTEWATER DISPOSAL PLAN

Scale: 1" = 20 Ft.

For Construction Details  
refer to Chapter 12 of  
Maine Plumbing Code  
(one copy included for applicant)

Total of 17 high capacity  
infiltrators.

7 units in Row A  
5 units in Row B  
5 units in Row C

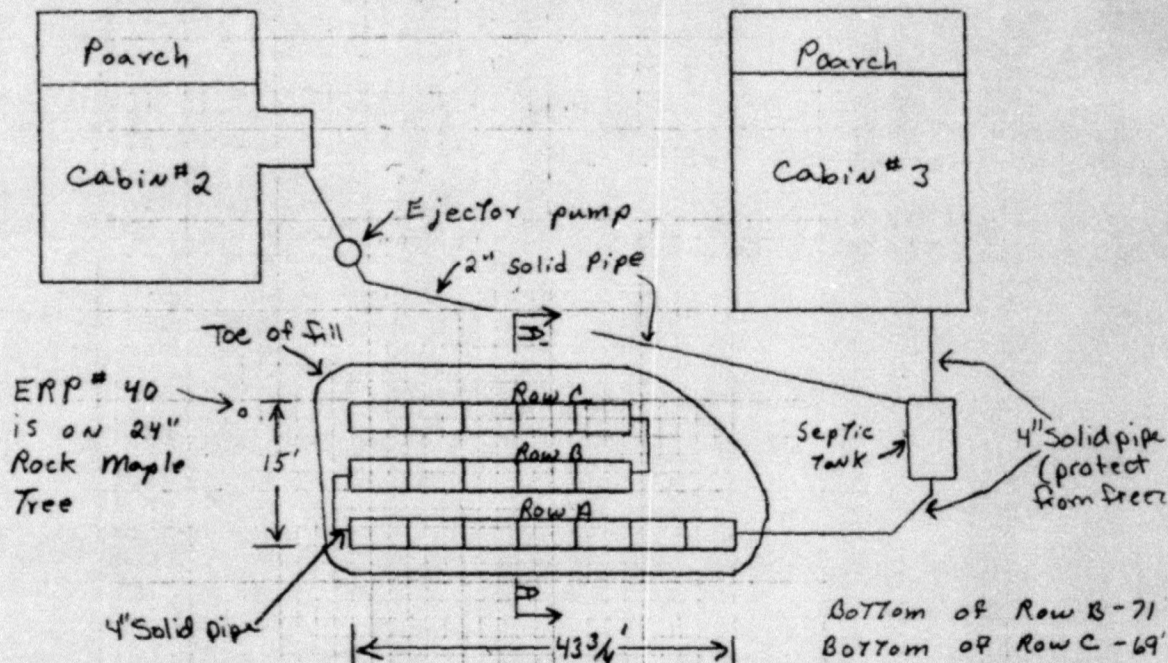

FILL REQUIREMENTS		CONSTRUCTION ELEVATIONS		ELEVATION REFERENCE POINT	
Depth of Fill (Upslope)	0	Finished Grade Elevation	-43"	Location & Description	Nail in Tag #40
Depth of Fill (Downslope)	2	Top of Distribution Pipe or Proprietary Device	-51"		Nail is 32" above ground level
		Bottom of Disposal Area	-62"	Reference & Elevation	0"

### DISPOSAL AREA CROSS SECTION

Scale:

Vertical: 1" = 5' Ft.

Scale: 1" = 5' Ft.

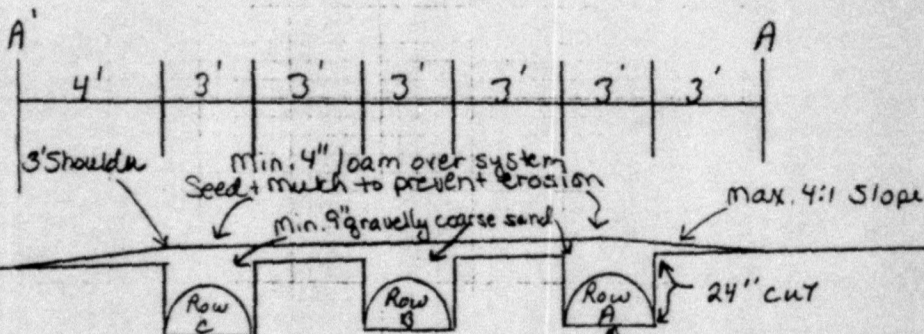

Remove all organic matter and  
scarify original soil under infiltrators and fill extensions

Fill between and over Infiltrators to be gravelly coarse sand

*John R. Whitney*  
Site Evaluator Signature

239  
SE #

Revised 8/26/98

5/5/98  
Date

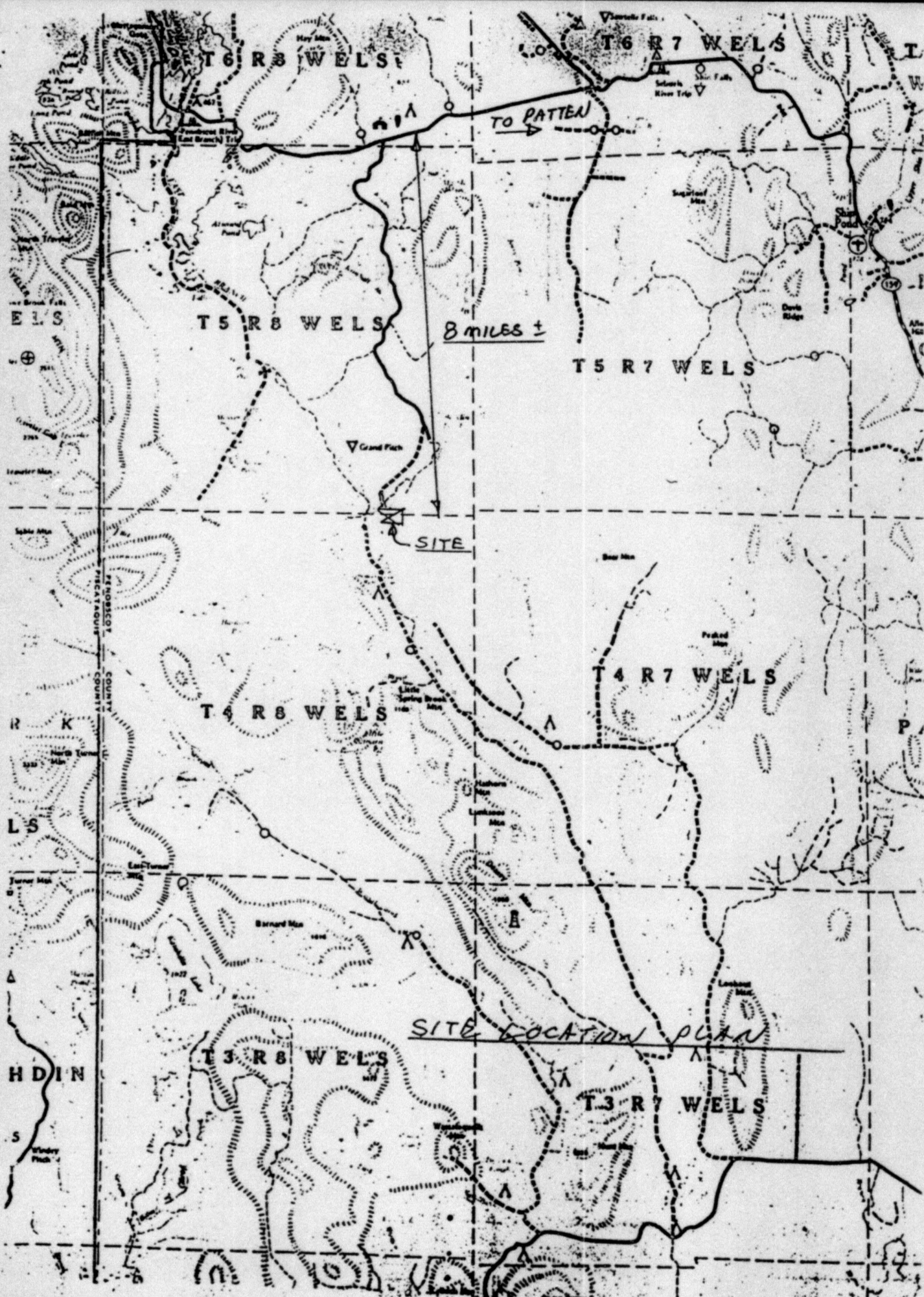





STATE OF MAINE  
DEPARTMENT OF HUMAN SERVICES  
11 STATE HOUSE STATION  
AUGUSTA, MAINE  
04333-0011

ANGUS S. KING, JR.  
GOVERNOR

KEVIN W. CONCANNON  
COMMISSIONER

October 20, 1998

Jon Smallwood  
PO Box 251  
Patten ME 04765

SUBJECT: Approval First Time System Variance Request, Smallwood property, Bowlin Camps  
Cabins 2 & 3, T5 R8

Dear Mr. Smallwood:

The Division has reviewed a replacement system variance request for the subject property. The state variance requested is to allow the installation of a subsurface wastewater disposal system with a reduction in gallons per day per bed for design flow determination. The system designed by John Whitney, SE, dated 8-26-98, is a redesign of two systems completed 5/4/98 and 5/5/98 for these camps; they will now share a system. The system design submitted is found to be in compliance with the Maine Subsurface Wastewater Disposal Rules.

We approve the variance request with the following requirements:

1. A permit for system installation is to be obtained from the Local Plumbing Inspector in advance of the start of system construction.
2. The system is to be installed in accordance with the submitted and approved system design. Should alterations to the design be required at the time of construction, the system designer is to be notified prior to making any changes.
3. The variance approval does not relieve the property owner from compliance with all other state and local requirements regarding the permitting, installing, and utilizing of the septic system.

Should you or others have any questions regarding this review and/or approval, please feel free to contact me at 287-5687.

Sincerely,

*Linda S. Robinson*

Linda S. Robinson  
Wastewater & Plumbing Control Program  
Division of Health Engineering  
e-mail: linda.robinson@state.me.us

/lsr  
cc: Claude Rounds, LPI  
John Whitney, SE  
Tom Allen, LURC (DP3976A)



# FIRST TIME SYSTEM VARIANCE REQUEST

This form shall accompany an Application (HHE-200) for a proposed first time system which requires a Variance to provisions of the Subsurface Wastewater Disposal Rules.

The local plumbing inspector shall not issue a permit for the installation of a first time subsurface wastewater disposal system requiring a variance from the Department of Human Services until approval has been received from them.

## GENERAL INFORMATION

Permit No. <u>308</u>	Town of <u>TPR</u>
Property Owner's Name: <u>Jon Smallwood</u>	Date Permit Issued: <u>11/10/98</u>
System's Location: <u>Bowling Camp cabins # 2+3</u>	Tel. No.: <u>207-528-2022</u>
Property Owner's Address: <u>P.O. Box 251 Patten, ME. 04765</u>	
(if different from above) _____	

## VARIANCE CONDITIONS

The Department has the authority to vary the requirements of the Rules in accordance with Section 105.2 of the Rules CMR 241 if all the following criteria are satisfied:

- a. The variance request has the approval of the LPI.
- b. The Municipal Officials have indicated that the variance does not conflict with any local wastewater disposal ordinances.
- c. The variance request demonstrates that there is no practical alternative for wastewater disposal, such as access to public sewer or the potential for an easement.
- d. The proposed system does not conflict with any provision controlling subsurface wastewater disposal in the Shoreland Zone.
- e. The site offers potential for a system which will dispose of the wastewater with minimal threat to public health, safety, or welfare.
- f. The property owner has indicated an awareness of the variance and any limitations or added costs the proposed system may require.

## SOIL, SITE AND ENGINEERING FACTORS FOR NEW SYSTEM VARIANCE ASSESSMENT

(SEE TABLES 2000.1-2000.10)

	CHARACTERISTIC	POINT ASSESSMENT
Soil Profile		
Depth to Groundwater/Restrictive Layer		
Terrain		
Size of Property		
Waterbody Setback		
Water Supply		
Type of Development		
Disposal Area Adjustment		
Vertical Separation Adjustment		
Additional Treatment		
<b>TOTAL POINT ASSESSMENT (Sec. 2003.6)</b>		

Minimum Points (Check one): Outside Shoreland-50 ☐ Inside Shoreland-65 ☐ Subdivision-65 ☐

## SPECIFIC VARIANCE REQUESTED (To be filled in by Site Evaluator)

## SECTION OF RULE

1. <u>Reduction of water flow from 50 GPD/bed to 35</u>	Table <u>901.2</u>
2. _____	_____
3. _____	_____

## SITE EVALUATOR

When a property is found to be unsuitable for subsurface wastewater disposal for a First Time System Variance by a Licensed Site Evaluator, the Evaluator shall so inform the property owner. If the property owner, after exploring all other alternatives, wishes to request a Variance to the Rules, and the Evaluator in his professional opinion feels the variance request is justified and the site limitations can be overcome, he shall document the soil and site conditions on the Application. The Evaluator shall list the specific variances necessary plus describe below the proposed system design and function. The Evaluator shall further describe how the specific site limitations are to be overcome, and provide any other support documentation as required prior to consideration by the Department.

(Use Additional Sheets, if needed)

This is a seasonal, remote hunting + fishing camp. Camp operates for only about 60 days/year. Even when cabins are rented very seldom are all beds being used.

I, John R. Whitney, S.E., certify that a variance to the Rules is necessary since a system cannot be installed which will completely satisfy all the Rule requirements. In my judgment, the proposed system design on the attached Application is the best alternative available. enhances the potential of the site for subsurface wastewater disposal; and that the system should function properly.

John R. Whitney # 239      2/26/98  
 SIGNATURE OF SITE EVALUATOR      DATE



First Time System Variance Request

**PROPERTY OWNER**

I, Jon Smallwood

am the ☐ owner ☒ agent for the owner of the subject property. I understand that the installation on the Application is not in total compliance with the Rules. Should the proposed system malfunction, I release all concerned provided they have performed their duties in a reasonable and proper manner, and I will promptly notify the Local Plumbing Inspector and make any corrections required by the Rules. By signing the variance request form, I acknowledge permission for representatives of the Department to enter onto the property to perform such duties as may be necessary to evaluate the variance request.

Jon Smallwood  
☐ SIGNATURE OF OWNER  
☒ AGENT FOR THE OWNER

10-7-98  
 DATE

**MUNICIPAL OFFICER(S)** (Selectman, Councilman, Alderman, Mayor, Town Manager)

We, the Municipal Officer(s) of \_\_\_\_\_ have reviewed this application and are aware that the applicant is applying for a First Time System Variance to the Subsurface Wastewater Disposal Rules because the proposed system does not meet all requirements of the rules. The proposed variance request ☐ does ☐ does not comply with all Municipal Ordinances relating to subsurface wastewater disposal.

\_\_\_\_\_  
 SIGNATURE FOR THE MUNICIPALITY

\_\_\_\_\_  
 TITLE

\_\_\_\_\_  
 DATE

**LOCAL PLUMBING INSPECTOR - Approval at local level**

The local plumbing inspector shall review all First Time System Variance requests prior to rendering a decision.

I, \_\_\_\_\_, the undersigned, have visited the above property and find that the variance request submitted by the applicant does not conform with certain provisions of the wastewater disposal rules. The variance request submitted by the applicant is the best alternative for a subsurface wastewater disposal system on this property. The proposed system ☐ does ☐ does not conflict with any provisions controlling subsurface wastewater disposal in the shoreland zone.

Therefore, I ☐ do ☐ do not approve the requested variance. I ☐ will ☐ will not issue a permit for the system's installation as proposed by the application.

\_\_\_\_\_  
 LPI Signature

\_\_\_\_\_  
 Date

**LOCAL PLUMBING INSPECTOR - Referral to the Department**

Site Visit = Aug 15, 1998

The local plumbing inspector shall review all First Time System Variance requests prior to forwarding to the Division of Health Engineering.

I, CLAUDE E. ROUNDS, the undersigned, have visited the above property and find that the variance request submitted by the applicant does not conform with certain provisions of the wastewater disposal rules. The variance request submitted by the applicant is the best alternative for a subsurface wastewater disposal system on this property. The proposed system ☐ does ☒ does not conflict with any provisions controlling subsurface wastewater disposal in the shoreland zone.

Therefore, I ☒ do ☐ do not recommend the issuance of a permit for the system's installation as proposed by the application.

Claude E. Rounds  
 LPI Signature

OCT 19, 1998  
 Date

**FOR USE BY THE DEPARTMENT ONLY**

The Department has reviewed the variance(s) and ☒ does ☐ does not give its approval. Any additional requirements, recommendations, or reasons for the Variance ~~denial~~, are given in the attached letter.

Lindal Robinson  
 SIGNATURE OF THE DEPARTMENT

10-20-98  
 DATE

- Note 1. Variances for soil conditions may be approved at the local level as long as the total point assessment is at least the minimum allowed. (See Section 1902.0 for Municipal Review.)
2. Variances for other than soil conditions or soil conditions beyond the limit of the LPI's authority are to be submitted to the Department for review. (See Section 1901.0 for Department Review.) The LPI's signature is required on these variance requests prior to sending them to the Department.