



APPLICATION FOR
MAINE TREE GROWTH TAX LAW PROGRAM

36 M.R.S. §§ 571-584-A

See Property Tax Bulletin No. 19 for more information

ASSESSOR'S USE ONLY
Recertification Date:

1. Name of owner(s): NORVEST LLC
2. Mailing address: 203 STEPHENS ROAD
WEST MILFORD, NJ 07480 Phone: 9737283686
3. Location of parcel (municipality and county): _____
4. Identification of parcel: PE024 PLAN 01 LOTS 1.3 & 1.4

Tax Map

Plan

Lot

5. Forest land used for commercial forest production

Type	Number of Acres
a. Softwood	<u>3</u>
b. Mixed wood	<u>8</u>
c. Hardwood	<u>0</u>
d. TOTAL ACRES (add lines 5a through 5c).....	5d. <u>11</u>

6. Land unsuitable for commercial forest production

Type	Number of Acres
a. Natural water and man-made water areas.....	_____
b. Wetlands (swamp, marsh)	_____
c. Ledges and barrens	_____
d. TOTAL ACRES (add lines 6a through 6c).....	6d. <u>0</u>

7. Land not used primarily for commercial forest production

Type	Number of Acres
a. Building area	<u>2</u>
b. Fields	_____
c. Gravel pits	_____
d. Transmission line or pipeline right-of-way area	_____
e. Class I roads (includes culverts, ditching, gravel).....	_____
f. Class II roads (unimproved haul road).....	_____
g. Agricultural area (list _____)	_____
h. Other areas (list _____)	_____
i. TOTAL ACRES (add lines 7a through 7h).....	7i. <u>2</u>

8. TOTAL AREA OF PARCEL (Add 5d, 6d and 7i) 8. 13

9. Check one. A licensed forester must complete the Forester Section below.

- ☐ Initial request for classification of this parcel in the Tree Growth Tax Law program. **You must file this application on or before April 1.**
- ☐ Application for an existing classified parcel with a new forest management and harvest plan.
- ☐ Application for a new owner of an existing classified parcel adopting the previous owner's forest management and harvest plan. Date of the plan prepared for the parcel: _____.
- ☒ Recertification of the forest management and harvest plan for an existing classified parcel.
- ☐ Application submitted at the request of the assessor.

10. Are there any structures or improvements on the property? ☒ Yes ☐ No

11. Under penalties of perjury, I declare that I have examined this application and to the best of my knowledge and belief it is true, correct, and complete. I swear that, as owner of the property classified under the Tree Growth Tax Law, my primary use for the forest land is to grow trees to be harvested for commercial use or that the forest land is land described in 36 M.R.S. § 573(3) and that I will follow the provisions of the applicable forest management and harvest plan. I declare that all owners of the parcel agree to classification of the parcel under the Tree Growth Tax Law.

[Signature]
Signature of Owner/Authorized Agent*

12/30/2020
Date

*Multiple owners: If all owners agree to classification of the property under Tree Growth Tax Law, the owner's authorized agent may sign this form.

FORESTER SECTION: This section is to be completed by the forester

Name of licensed forester who approved/prepared the plan: DALE L. ROBINSON

Forester license number: 3322 Forester telephone number: 207-570-4521

Date plan prepared: 3/18/10 Date plan expires: 3/18/30 Date parcel inspected: 12/11/20

The forester's signature is required if plan is adopted from prior owner or for recertification of the forest management and harvest plan. Check the appropriate box.

- ☐ For a plan adopted by a new owner following a land transfer, I hereby swear that the new owner is managing the forest land in accordance with the plan prepared for the previous landowner.
- ☒ For a plan being recertified, I hereby swear that I have inspected the parcel and that the owner is managing the parcel according to the forest management and harvest plan.

Dale L. Robinson
Signature of Licensed Forester

Date

ASSESSOR SECTION: This section is to be completed by the assessor ☐ Approved ☐ Denied

Assessor's Signature

Date

9. Check one. A licensed forester must complete the Forester Section below.

- ☐ Initial request for classification of this parcel in the Tree Growth Tax Law program. **You must file this application on or before April 1.**
- ☐ Application for an existing classified parcel with a new forest management and harvest plan.
- ☐ Application for a new owner of an existing classified parcel adopting the previous owner's forest management and harvest plan. Date of the plan prepared for the parcel: _____.
- ☒ Recertification of the forest management and harvest plan for an existing classified parcel.
- ☐ Application submitted at the request of the assessor.

10. Are there any structures or improvements on the property? ☒ Yes ☐ No

11. Under penalties of perjury, I declare that I have examined this application and to the best of my knowledge and belief it is true, correct, and complete. I swear that, as owner of the property classified under the Tree Growth Tax Law, my primary use for the forest land is to grow trees to be harvested for commercial use or that the forest land is land described in 36 M.R.S. § 573(3) and that I will follow the provisions of the applicable forest management and harvest plan. I declare that all owners of the parcel agree to classification of the parcel under the Tree Growth Tax Law.

Henry L. Leary
Signature of Owner/Authorized Agent*

12/30/2020
Date

*Multiple owners: If all owners agree to classification of the property under Tree Growth Tax Law, the owner's authorized agent may sign this form.

FORESTER SECTION: This section is to be completed by the forester

Name of licensed forester who approved/prepared the plan: DALE L. ROBINSON

Forester license number: 3322 Forester telephone number: 207-570-4521

Date plan prepared: 3/18/10 Date plan expires: 3/18/30 Date parcel inspected: 12/11/20

The forester's signature is required if plan is adopted from prior owner or for recertification of the forest management and harvest plan. Check the appropriate box.

- ☐ For a plan adopted by a new owner following a land transfer, I hereby swear that the new owner is managing the forest land in accordance with the plan prepared for the previous landowner.
- ☒ For a plan being recertified, I hereby swear that I have inspected the parcel and that the owner is managing the parcel according to the forest management and harvest plan.

Dale L. Robinson
Signature of Licensed Forester

12/11/2020
Date

ASSESSOR SECTION: This section is to be completed by the assessor ☐ Approved ☐ Denied

Assessor's Signature









Date

FOREST TYPE MAP

PROPERTY OF
NORVEST, LLC

.R8 -- PE025 Plan 1 Lots 1.3 & 1.4
T5R8 -- PE025 Plan 1 Lot 3.11
Total Acres: +/- 31

Legend

-  Bowlin_Property
- Bowlin Forest Types**
-  SW-Softwood
-  MW-Mixed Wood
-  HW-Hardwood
-  Field
-  BA-Building Area
-  Town Lines
-  Streams

330 660 1,320 Feet

1:7,920



Forest Resource Management and Timberland Services

Prepared By: Dale L. Robinson LF #3322
Prentiss & Carlisle Mgt. Co.
07 Court St. Bangor, ME
November 11, 2020

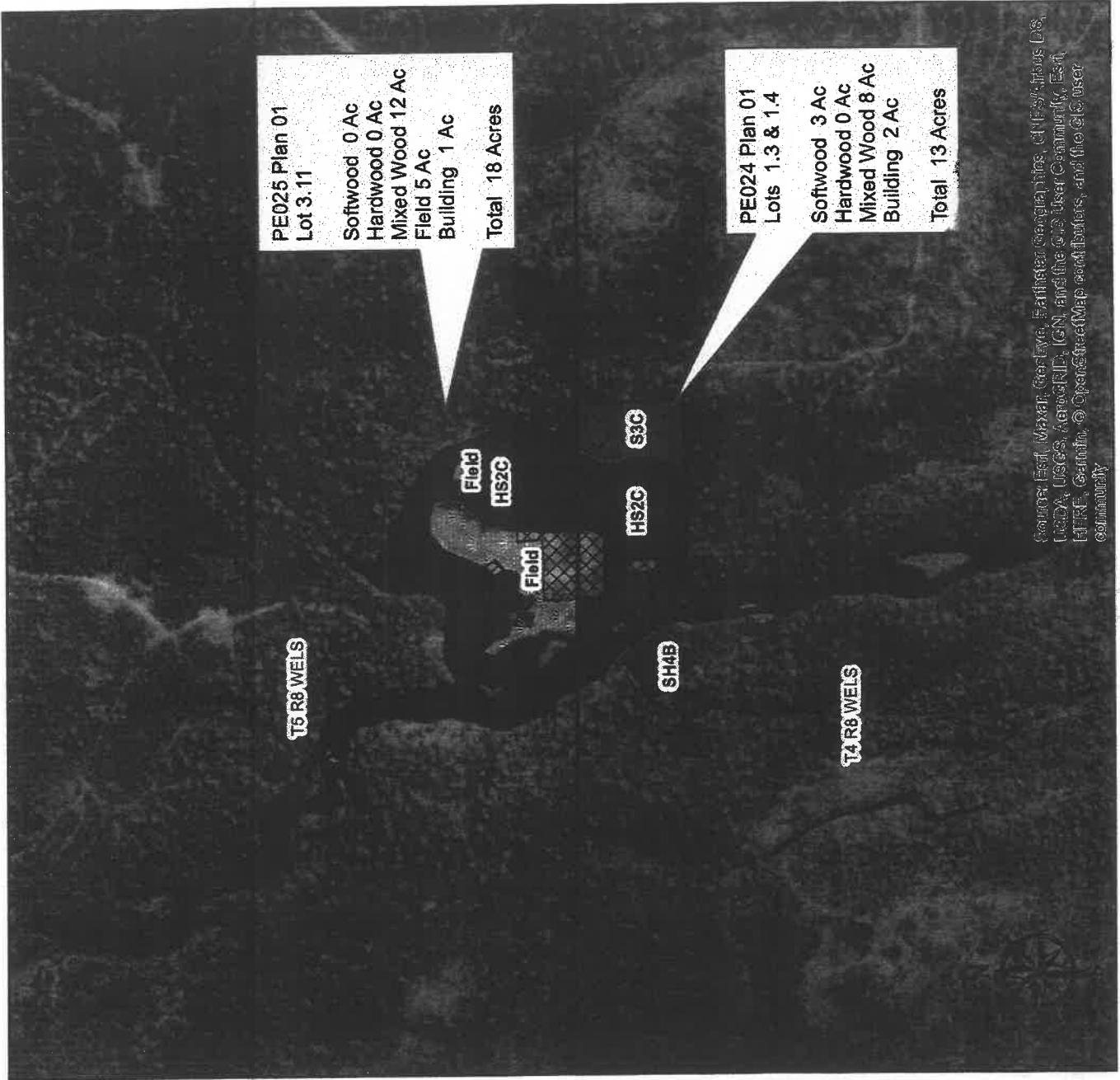

Source: Esri, Maxar, GeoEye, Earthstar Geographics, CNES/Airbus DS, USDA, USGS, AeroGRID, IGN, and the GIS User Community, Esri, HERE, Garmin, © OpenStreetMap contributors, and the GIS User Community

This is not a legal survey.

ASSESSOR'S USE ONLY
Recertification Date:

**APPLICATION FOR
MAINE TREE GROWTH TAX LAW PROGRAM**

36 M.R.S. §§ 571-584-A

See Property Tax Bulletin No. 19 for more information

1. Name of owner(s): NORVEST LLC
2. Mailing address: 203 STEPHENS ROAD
WEST MILFORD, NJ 07480 Phone: 9737283686

3. Location of parcel (municipality and county): _____

4. Identification of parcel: PE025 PLAN 01 LOTS 3.11

Tax Map

Plan

Lot

5. Forest land used for commercial forest production

Type	Number of Acres
a. Softwood	<u>0</u>
b. Mixed wood	<u>12</u>
c. Hardwood	<u>0</u>
d. TOTAL ACRES (add lines 5a through 5c).....	5d. <u>12</u>

6. Land unsuitable for commercial forest production

Type	Number of Acres
a. Natural water and man-made water areas.....	_____
b. Wetlands (swamp, marsh)	_____
c. Ledges and barrens	_____
d. TOTAL ACRES (add lines 6a through 6c).....	6d. <u>0</u>

7. Land not used primarily for commercial forest production

Type	Number of Acres
a. Building area	<u>1</u>
b. Fields	<u>5</u>
c. Gravel pits	_____
d. Transmission line or pipeline right-of-way area	_____
e. Class I roads (includes culverts, ditching, gravel).....	_____
f. Class II roads (unimproved haul road).....	_____
g. Agricultural area (list _____)	_____
h. Other areas (list _____)	_____
i. TOTAL ACRES (add lines 7a through 7h).....	7i. <u>6</u>

8. **TOTAL AREA OF PARCEL** (Add 5d, 6d and 7i) 8. 18

**APPLICATION FOR
MAINE TREE GROWTH TAX LAW PROGRAM**

36 M.R.S. §§ 571-584-A

See Property Tax Bulletin No. 19 for more information

ASSESSOR'S USE ONLY
Recertification Date: _____

1. Name of owner(s): NORVEST LLC
2. Mailing address: 203 STEPHENS ROAD
WEST MILFORD, NJ 07480 Phone: 9737283686
3. Location of parcel (municipality and county): _____
4. Identification of parcel: PE025 PLAN 01 LOTS 3.11

Tax Map

Plan

Lot

5. Forest land used for commercial forest production

Type	Number of Acres
a. Softwood	<u>0</u>
b. Mixed wood	<u>12</u>
c. Hardwood	<u>0</u>
d. TOTAL ACRES (add lines 5a through 5c).....	5d. <u>12</u>

6. Land unsuitable for commercial forest production

Type	Number of Acres
a. Natural water and man-made water areas.....	_____
b. Wetlands (swamp, marsh)	_____
c. Ledges and barrens	_____
d. TOTAL ACRES (add lines 6a through 6c).....	6d. <u>0</u>

7. Land not used primarily for commercial forest production

Type	Number of Acres
a. Building area	<u>1</u>
b. Fields	<u>5</u>
c. Gravel pits	_____
d. Transmission line or pipeline right-of-way area	_____
e. Class I roads (includes culverts, ditching, gravel).....	_____
f. Class II roads (unimproved haul road).....	_____
g. Agricultural area (list _____)	_____
h. Other areas (list _____)	_____
i. TOTAL ACRES (add lines 7a through 7h).....	7i. <u>6</u>

8. **TOTAL AREA OF PARCEL** (Add 5d, 6d and 7i) 8. 18

9. Check one. A licensed forester must complete the Forester Section below.

- ☐ Initial request for classification of this parcel in the Tree Growth Tax Law program. **You must file this application on or before April 1.**
- ☐ Application for an existing classified parcel with a new forest management and harvest plan.
- ☐ Application for a new owner of an existing classified parcel adopting the previous owner's forest management and harvest plan. Date of the plan prepared for the parcel: _____.
- ☒ Recertification of the forest management and harvest plan for an existing classified parcel.
- ☐ Application submitted at the request of the assessor.

10. Are there any structures or improvements on the property? ☒ Yes ☐ No

11. Under penalties of perjury, I declare that I have examined this application and to the best of my knowledge and belief it is true, correct, and complete. I swear that, as owner of the property classified under the Tree Growth Tax Law, my primary use for the forest land is to grow trees to be harvested for commercial use or that the forest land is land described in 36 M.R.S. § 573(3) and that I will follow the provisions of the applicable forest management and harvest plan. I declare that all owners of the parcel agree to classification of the parcel under the Tree Growth Tax Law.

[Signature]
Signature of Owner/Authorized Agent*

12/31/2020
Date

*Multiple owners: If all owners agree to classification of the property under Tree Growth Tax Law, the owner's authorized agent may sign this form.

FORESTER SECTION: This section is to be completed by the forester

Name of licensed forester who approved/prepared the plan: DALE L. ROBINSON

Forester license number: 3322 Forester telephone number: 207-570-4521

Date plan prepared: 3/18/10 Date plan expires: 3/18/30 Date parcel inspected: 12/11/20

The forester's signature is required if plan is adopted from prior owner or for recertification of the forest management and harvest plan. Check the appropriate box.

- ☐ For a plan adopted by a new owner following a land transfer, I hereby swear that the new owner is managing the forest land in accordance with the plan prepared for the previous landowner.
- ☒ For a plan being recertified, I hereby swear that I have inspected the parcel and that the owner is managing the parcel according to the forest management and harvest plan.

Dale L. Robinson
Signature of Licensed Forester

12/11/2020
Date

ASSESSOR SECTION: This section is to be completed by the assessor ☐ Approved ☐ Denied

Assessor's Signature

Date

9. Check one. A licensed forester must complete the Forester Section below.

- ☐ Initial request for classification of this parcel in the Tree Growth Tax Law program. **You must file this application on or before April 1.**
- ☐ Application for an existing classified parcel with a new forest management and harvest plan.
- ☐ Application for a new owner of an existing classified parcel adopting the previous owner's forest management and harvest plan. Date of the plan prepared for the parcel: _____.
- ☒ Recertification of the forest management and harvest plan for an existing classified parcel.
- ☐ Application submitted at the request of the assessor.

10. Are there any structures or improvements on the property? ☒ Yes ☐ No

11. Under penalties of perjury, I declare that I have examined this application and to the best of my knowledge and belief it is true, correct, and complete. I swear that, as owner of the property classified under the Tree Growth Tax Law, my primary use for the forest land is to grow trees to be harvested for commercial use or that the forest land is land described in 36 M.R.S. § 573(3) and that I will follow the provisions of the applicable forest management and harvest plan. I declare that all owners of the parcel agree to classification of the parcel under the Tree Growth Tax Law.

[Signature]
Signature of Owner/Authorized Agent*

12/31/2020
Date

*Multiple owners: If all owners agree to classification of the property under Tree Growth Tax Law, the owner's authorized agent may sign this form.

FORESTER SECTION: This section is to be completed by the forester

Name of licensed forester who approved/prepared the plan: DALE L. ROBINSON

Forester license number: 3322 Forester telephone number: 207-570-4521

Date plan prepared: 3/18/10 Date plan expires: 3/18/30 Date parcel inspected: 12/11/20

The forester's signature is required if plan is adopted from prior owner or for recertification of the forest management and harvest plan. Check the appropriate box.

- ☐ For a plan adopted by a new owner following a land transfer, I hereby swear that the new owner is managing the forest land in accordance with the plan prepared for the previous landowner.
- ☒ For a plan being recertified, I hereby swear that I have inspected the parcel and that the owner is managing the parcel according to the forest management and harvest plan.

Dale L. Robinson
Signature of Licensed Forester

Date

ASSESSOR SECTION: This section is to be completed by the assessor ☐ Approved ☐ Denied

Assessor's Signature









Date

FOREST TYPE MAP

PROPERTY OF
NORVEST, LLC

T4R8 -- PE025 Plan 1 Lots 1.3 & 1.4
T5R8 -- PE025 Plan 1 Lot 3.11
Total Acres: +/- 31

Legend

-  Bowlin_Property
- Bowlin Forest Types**
-  SW-Softwood
-  MW-Mixed Wood
-  HW-Hardwood
-  Field
-  BA-Building Area
-  Town Lines
-  Streams

0 330 660 1,320 Feet

1:7,920



Forest Resource Management and Timberland Services

Prepared By: Dale L. Robinson LF #3322
Penttiss & Carlisle Mgt. Co.
107 Court St. Bangor, ME
November 11, 2020

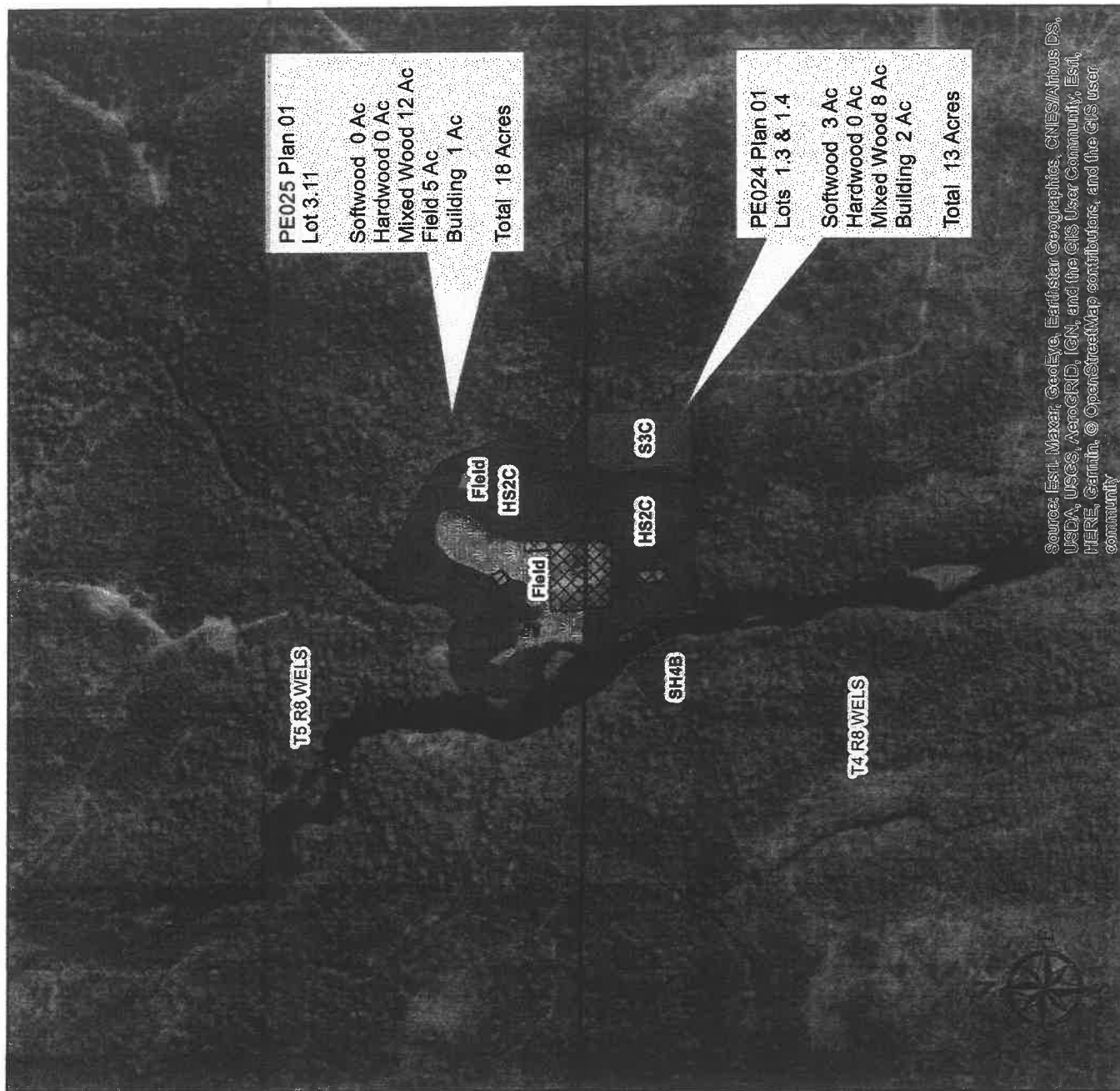

Source: Esri, Maxar, GeoEye, Earthstar Geographics, CNES/Airbus DS, USDA, USGS, AeroGRID, IGN, and the GIS User Community, Esri, HERE, Garmin, © OpenStreetMap contributors, and the GIS user community

This is not a legal survey.